

**PLAN OF PROPOSED SUBDIVISION OF
S.L. 3, STRATA PLAN KAS2234, D.L.'s 72 & 1309, O.D.Y.D.
SCALE 1: 250 (ALL DISTANCES IN METRES)**

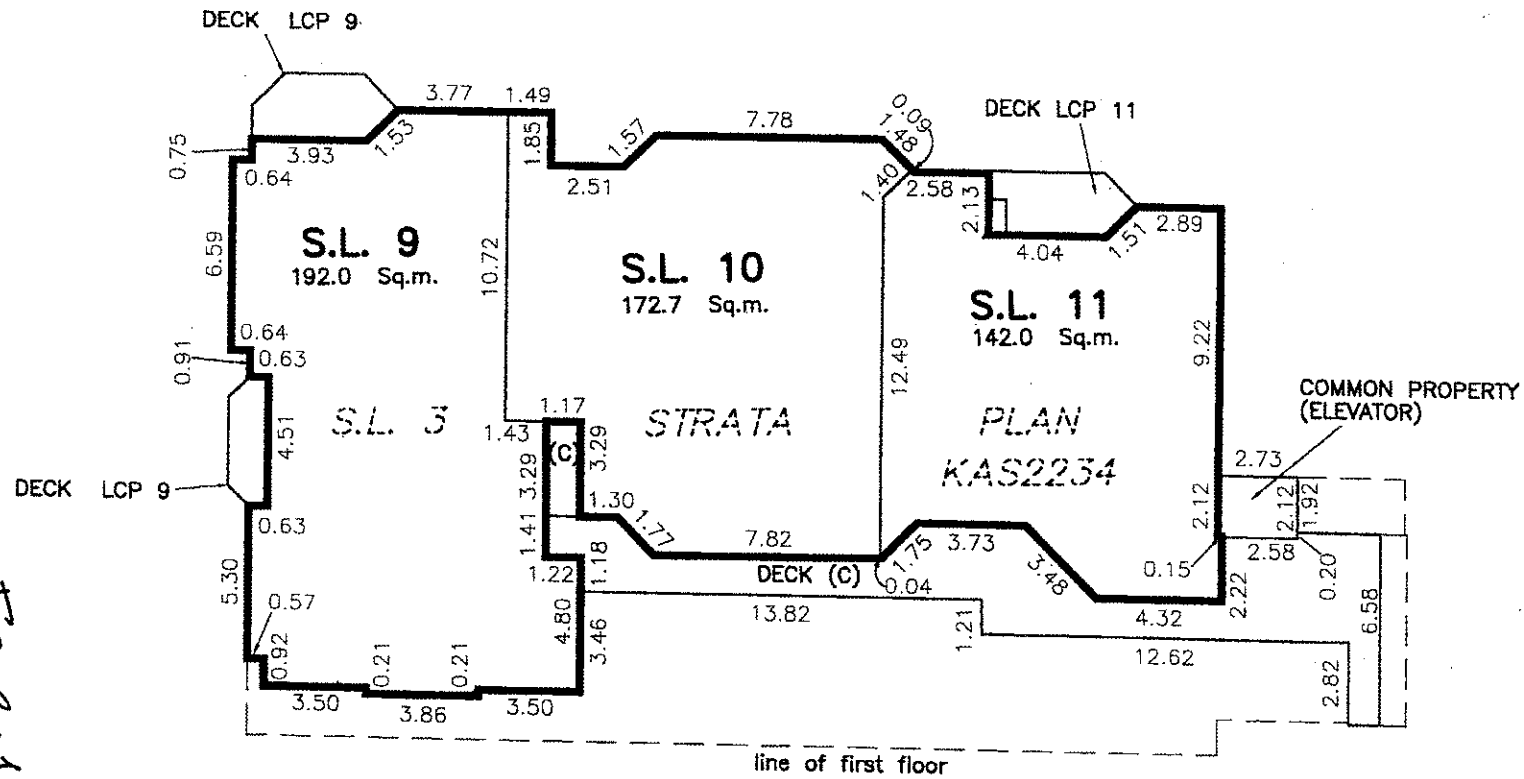

FIGURE 1
DMR

RUSSELL N. SHORTT
British Columbia Land Surveyor

2801-32nd Street, Vernon, B.C. Phone 545-0511

FAX: 545-2741
FILE No. 24929

20000403.1526

FEBRUARY 5TH, 2007

THIS PLAN IS PREPARED FOR THE USE OF:
BOB McDONNELL